

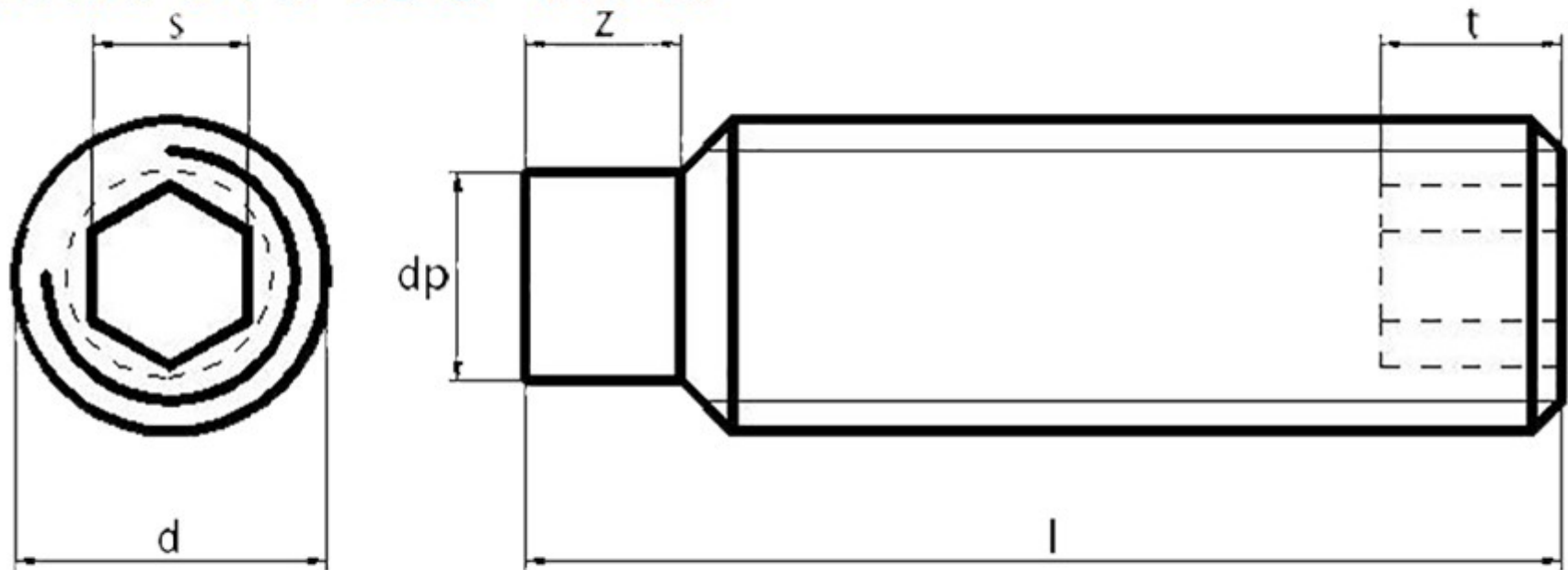

Ever Hardware Industrial Limited

DIN 915 ISO 4028



d	M1.4	M1.6	M1.8	M2	M2.5	M3	M4	M5	M6	M8	M10	M12	M14
p	0.3	0.35	0.35	0.4	0.45	0.5	0.7	0.8	1.0	1.25	1.5	1.75	2.0
dp max	0.7	0.8	0.9	1.0	1.5	2.0	2.5	3.5	4.0	5.5	8.5	8.5	10.0
dp min	0.45	0.55	0.65	0.75	1.25	1.75	2.25	3.2	3.7	5.2	8.14	8.14	9.64
s	0.7	0.7	0.7	0.9	1.3	1.5	2.0	2.5	3.0	4.0	6.0	6.0	6.0
t min	0.6	0.6	0.8	0.8	1.2	1.2	1.5	2.0	2.0	3.0	4.0	4.8	5.6
z max	1.05	1.05	1.25	1.25	1.5	1.75	2.25	2.75	3.25	4.3	5.3	6.3	7.36
z min	0.8	0.8	1.0	1.0	1.25	1.5	2.0	2.5	3.0	4.0	5.0	6.0	7.0