

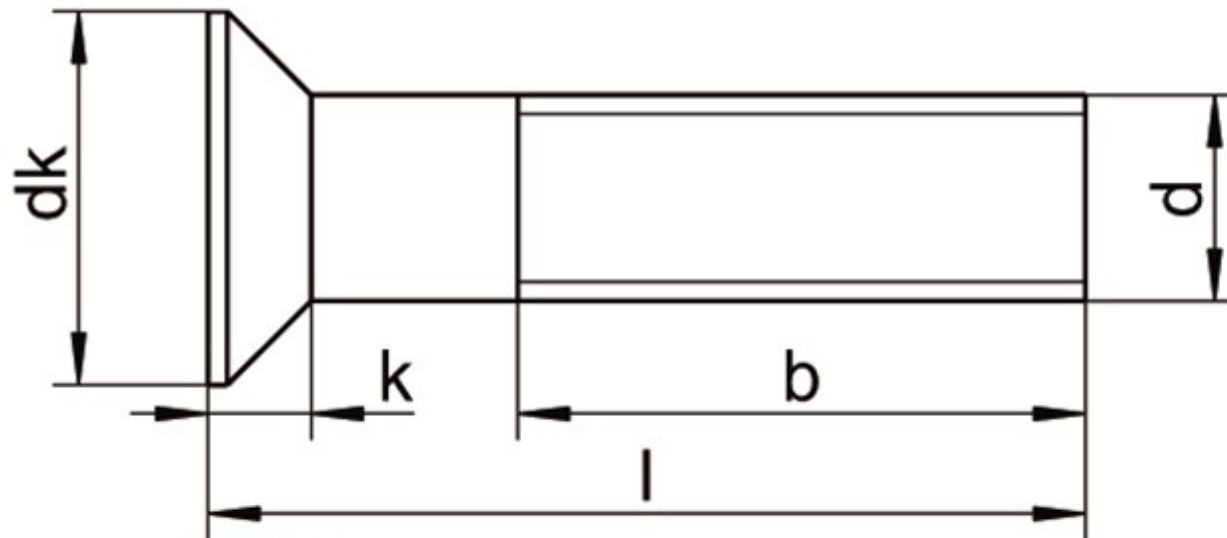

**Ever Hardware Industrial Limited**

**DIN 965 ISO 7046**

**Countersunk Head Machine Screw**



d	M1.6	M2	M2.5	M3	M4	M5	M6	M8	M10
dk	3.0	3.8	4.7	5.6	7.5	9.2	11	14.5	18
p	0.35	0.4	0.45	0.5	0.7	0.8	1.0	1.25	1.5
k	0.96	1.2	1.5	1.65	2.2	2.5	3.0	4.0	5.0
drive	#0	#1	#1	#1	#1	#2	#2	#2	#3