

## DIN 9841 ISO 7379

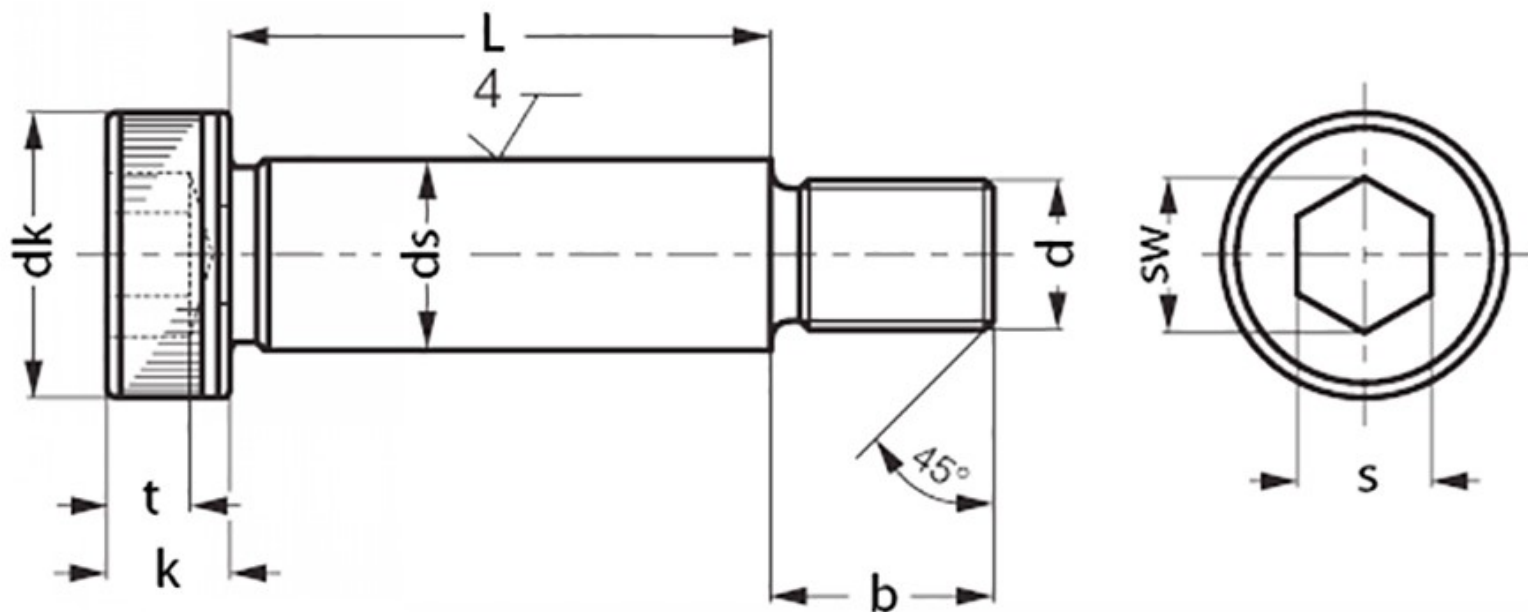

d	M5	M6	M8	M10	M12	M16	M20
ds	6.5	8.0	10.0	13.0	16.0	20.0	25.0
p	0.8	1.0	1.25	1.5	1.75	2.0	2.5
b max	9.75	11.25	13.25	16.40	18.40	22.40	27.40
b min	9.25	10.75	12.75	15.60	17.60	21.60	26.60
dk max	10.22	13.27	16.27	18.27	24.33	30.33	36.39
dk min	9.78	12.73	15.73	17.73	23.67	29.67	35.61
k max	4.5	5.5	7.0	9.0	11.0	14.0	16.0
k min	4.32	5.32	6.78	8.78	10.73	13.73	15.73
s	3.0	4.0	5.0	6.0	8.0	10.0	12.0
t min	2.4	3.3	4.2	4.9	6.6	8.8	10.0